

# Self-Lubricating Gib Assemblies | Base Plates for Assemblies

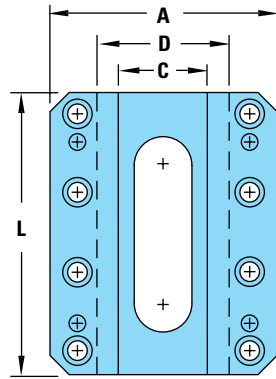

## Self-Lubricating Gib Assemblies – SLA

**Material:** Aluminum Bronze with Graphite Plugs  
**Hardness:** 179 Bhn

ITEM NUMBER	H	A	L	B	C	D	E
SLA1001	1.12	2.62	2.00	.312	1.12	1.50	.75
SLA1002	1.12	2.62	3.00	.312	1.12	1.50	.75
SLA1003	1.12	2.62	4.00	.312	1.12	1.50	.75
SLA2001	1.12	3.12	3.00	.375	1.12	1.62	.75
SLA2002	1.12	3.12	4.00	.375	1.12	1.62	.75
SLA2003	1.12	3.12	5.00	.375	1.12	1.62	.75
SLA3001	1.25	4.12	3.00	.500	1.62	2.36	.88
SLA3002	1.25	4.12	4.00	.500	1.62	2.36	.88
SLA3003	1.25	4.12	5.00	.500	1.62	2.36	.88
SLA3004	1.25	4.12	6.00	.500	1.62	2.36	.88
SLA4001	1.62	4.62	4.00	.750	1.62	2.62	1.25
SLA4002	1.62	4.62	5.00	.750	1.62	2.62	1.25
SLA4003	1.62	4.62	6.00	.750	1.62	2.62	1.25

- Standardized assembly
- Wide variety of applications
- Easily installed in pre-machined pocket
- Reduces design and assembly time

The Gib Assembly includes three components: two L-Gibs and a Base Plate. The L-Gibs are provided with screw holes and are spot-drilled for dowels; the Base Plate includes thru holes to allow for easy assembly.

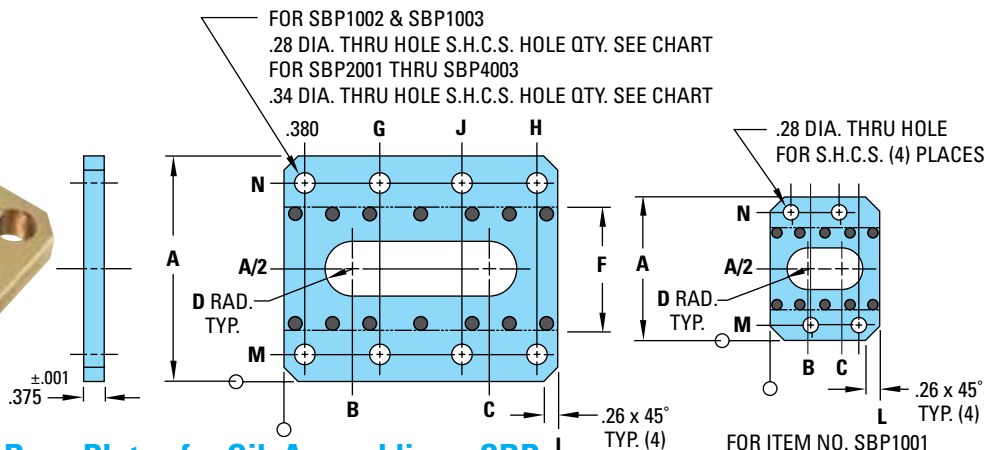
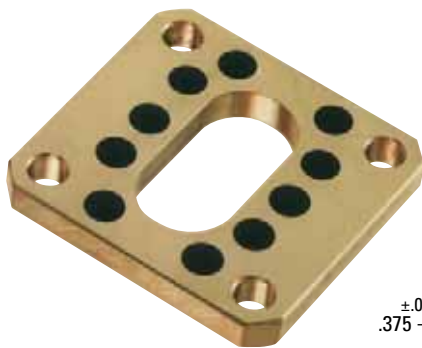
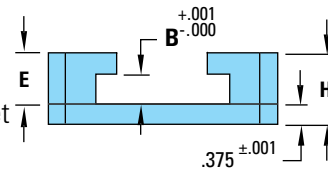

## Base Plates for Gib Assemblies – SBP

**Material:** Aluminum Bronze with Graphite Plugs **Hardness:** 179 Bhn

ITEM NUMBER	A	L	B	C	D	F	G	H	J	M	N	MOUNTING HOLE QTY
SBP1001	2.620	2.00	.69	1.31	.38	1.50	.740	1.62	1.260	.280	2.340	4
SBP1002	2.620	3.00	.88	2.12	.38	1.50	—	2.620	—	.280	2.340	4
SBP1003	2.620	4.00	1.00	3.00	.38	1.50	2.000	3.620	—	.280	2.340	6
SBP2001	3.120	3.00	.88	2.12	.38	1.68	—	2.620	—	.370	2.750	4
SBP2002	3.120	4.00	1.00	3.00	.38	1.68	2.000	3.620	—	.370	2.750	6
SBP2003	3.120	5.00	1.12	3.88	.38	1.68	2.500	4.620	—	.370	2.750	6
SBP3001	4.120	3.00	1.00	2.00	.50	2.25	—	2.620	—	.495	3.625	4
SBP3002	4.120	4.00	1.12	2.88	.50	2.25	2.000	3.620	—	.495	3.625	6
SBP3003	4.120	5.00	1.25	3.75	.50	2.25	2.500	4.620	—	.495	3.625	6
SBP3004	4.120	6.00	1.50	4.50	.50	2.25	2.000	5.620	4.000	.495	3.625	8
SBP4001	4.620	4.00	1.12	2.88	.50	2.41	2.000	3.620	—	.560	4.060	6
SBP4002	4.620	5.00	1.25	3.75	.50	2.41	2.500	4.620	—	.560	4.060	6
SBP4003	4.620	6.00	1.50	4.50	.50	2.41	2.000	5.620	4.000	.560	4.060	8

**NOTES:**

- Tolerances not noted are ±.010, Hole locations are ±.005.
- Graphic plug pattern varies by product size.

All items in stock.

**WHEN ORDERING, PLEASE SPECIFY:**

- Item Numbers from charts
- Quantity
- Method of shipment

Slide Action Components | Self-Lubricating Gib Assemblies; Base Plates for Assemblies